

PROHS Equipamento Hospitalar
e Serviços Associados, S.A.

Rua do Castanhal, 316
Z. Industrial Maia I Sector II
Apartado 6019 EC Outeiro
4476-908 **Maia — Portugal**

| **T** | +351 229 059 170
| **F** | +351 229 015 900
| **E** | prohs@prohs.pt
| **W** | www.prohs.pt

Transfer Cabinet



PROHS®

Transfer Cabinet

PROHS transfer cabinet allows the transference of instruments or materials between adjacent rooms facilitating everyday routines in the sluice room.



Technical Characteristics

- Fully built in AISI 304L stainless steel.
- Manual door opening.
- Constructed within the building walls.
- Includes a quality wall coating around the cabinet on both sides.

Quatre portes

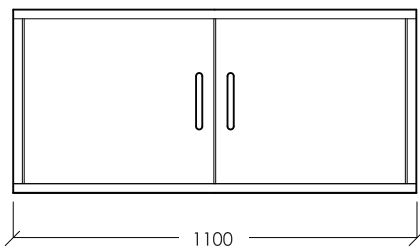

Accessories and Options

- Can be produced with custom dimensions.
- 2 doors or 4 doors.
- Mechanical Lock.
- Electric Loc.
- Door Locked indication.
- Interior Shelves Built in AISI 304L Stainless Steel.
- Doors can be made in Glass on one of the sides.

Deux portes

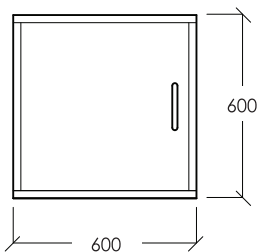

Due to product improvement and development, PROHS reserves the right to make changes without notice.